



NATIONAL CURRICULUM

KEY STAGE 1

USE TECHNOLOGY SAFELY AND RESPECTFULLY, KEEPING PERSONAL INFORMATION PRIVATE; IDENTIFY WHERE TO GO FOR HELP AND SUPPORT WHEN THEY HAVE CONCERNS ABOUT CONTENT OR CONTACT ON THE INTERNET OR OTHER ONLINE TECHNOLOGIES.

KEY STAGE 2

USE TECHNOLOGY **SAFELY, RESPECTFULLY AND RESPONSIBLY**; RECOGNISE ACCEPTABLE/UNACCEPTABLE BEHAVIOUR; IDENTIFY A RANGE OF WAYS TO REPORT CONCERNS ABOUT CONTENT AND CONTACT.

TOO MUCH SCREEN TIME?

- TELEVISION WATCHING TYPICALLY BEGINS AT 9 MONTHS OF AGE.
- IN A TYPICAL DAY, CHILDREN CONSUME JUST OVER THREE HOURS OF MEDIA. THIS INCLUDES COMPUTER USE, CELL PHONE USE, TABLET USE, MUSIC, AND READING. TWO THIRD OF THIS TIME IS SPENT WITH 'SCREEN MEDIA'
- BY AGE EIGHT ON A REGULAR BASIS, 96% OF CHILDREN HAVE WATCHED TV, 90% HAVE USED A COMPUTER, 81% HAVE PLAYED CONSOLE VIDEO GAMES, AND 60% HAVE PLAYED GAMES OR USED APPS ON A PORTABLE DEVICE.

GUIDELINES TO MANAGE MEDIA CONSUMPTION

KNOW YOUR KIDS AND KNOW YOUR VALUES

BE CONSCIOUS OF AGE-APPROPRIATENESS

SET FAMILY RULES AND STICK TO THEM

LIMIT SCREEN TIME

USE TECHNOLOGY TO CONTROL THE MEDIA

SET FAMILY VIEWING TIME

KEEP MEDIA OUT OF CHILDRENS' BEDROOMS

CONCERNS



Instagram

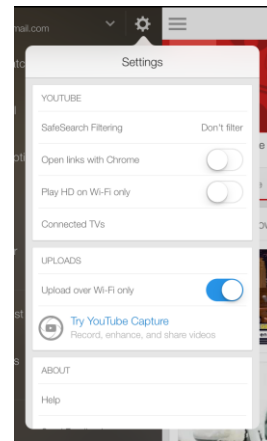

GAMING

ALL GAMES HAVE A PEGI RATING.



THESE AGE RATINGS ARE SYSTEMS USED TO ENSURE THAT ENTERTAINMENT CONTENT, SUCH AS FILMS, VIDEOS, DVDS, AND COMPUTER GAMES, ARE CLEARLY LABELLED FOR THE AGE GROUP FOR WHICH THEY ARE MOST SUITABLE. AGE RATINGS PROVIDE GUIDANCE TO CONSUMERS (PARTICULARLY PARENTS) TO HELP THEM DECIDE WHETHER OR NOT TO BUY A PARTICULAR PRODUCT.



E-SAFETY FOR ALL AGES



WAYS TO KEEP CHILDREN SAFE ONLINE

EXPLORE ONLINE TOGETHER

HAVE REGULAR CONVERSATIONS

MAKE SURE YOU KNOW WHAT YOUR CHILD IS DOING ONLINE

SET UP PARENTAL CONTROLS

MAKE SURE YOU KNOW HOW TO REPORT ABUSE



USEFUL WEBSITES

<https://www.thinkuknow.co.uk/parents>

<http://www.childnet.com/resources/kia/>

www.nspcc.org.uk/help-and-advice/for-parents/online-safety

www.getsafeonline.org

<http://www.internetmatters.org/>

<http://www.google.co.uk/safetycenter/families/start/>